

telescopic slide HG58T

basic type:

- side mounting
- part extension
- zinc-plated steel
- fixing holes

costum-made product:

- special lengths
- holes / hole center distances
- additional mounting elements
- combinations

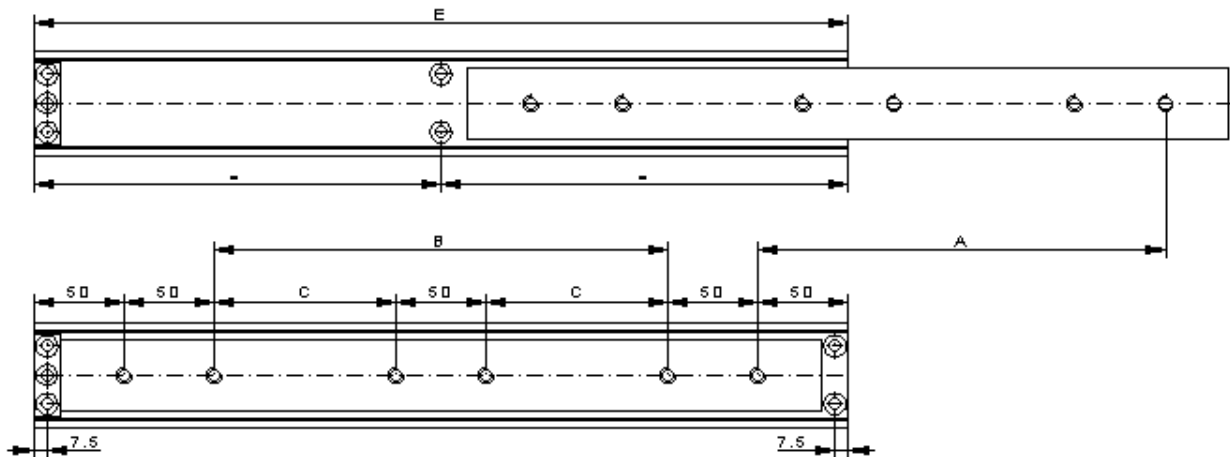
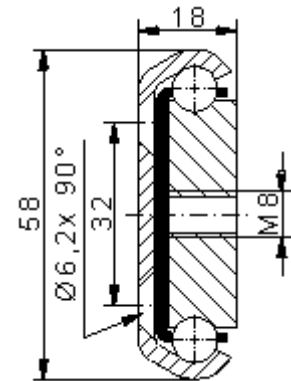

| installation length | length | | | hole pattern | | weight | travel length | load rating per pair |
|---------------------|--------|-----|-----|--------------|---|--------|---------------|----------------------|
| | 2 | B | C | 1 | 2 | | | |
| E | 2 | B | C | 1 | 2 | Kg | A | Kg |
| 300 | 270 | 100 | | 4 | 4 | 2,12 | 180 | 220 |
| 350 | 320 | 150 | | 4 | 4 | 2,47 | 230 | 230 |
| 400 | 370 | 200 | | 4 | 4 | 2,82 | 260 | 240 |
| 450 | 420 | 250 | | 4 | 4 | 3,18 | 310 | 250 |
| 500 | 470 | 300 | | 4 | 4 | 3,53 | 340 | 245 |
| 550 | 520 | | 150 | 6 | 6 | 3,88 | 370 | 240 |
| 600 | 570 | | 175 | 6 | 6 | 4,24 | 400 | 235 |
| 650 | 620 | | 200 | 6 | 6 | 4,6 | 430 | 230 |
| 700 | 670 | | 225 | 6 | 6 | 4,95 | 460 | 220 |
| 750 | 720 | | 250 | 6 | 6 | 5,3 | 490 | 210 |

telescopic slide HG58T

basic type:

- side mounting
- part extension
- zinc-plated steel
- fixing holes

costum-made product:

- special lengths
- holes / hole center distances
- additional mounting elements
- combinations

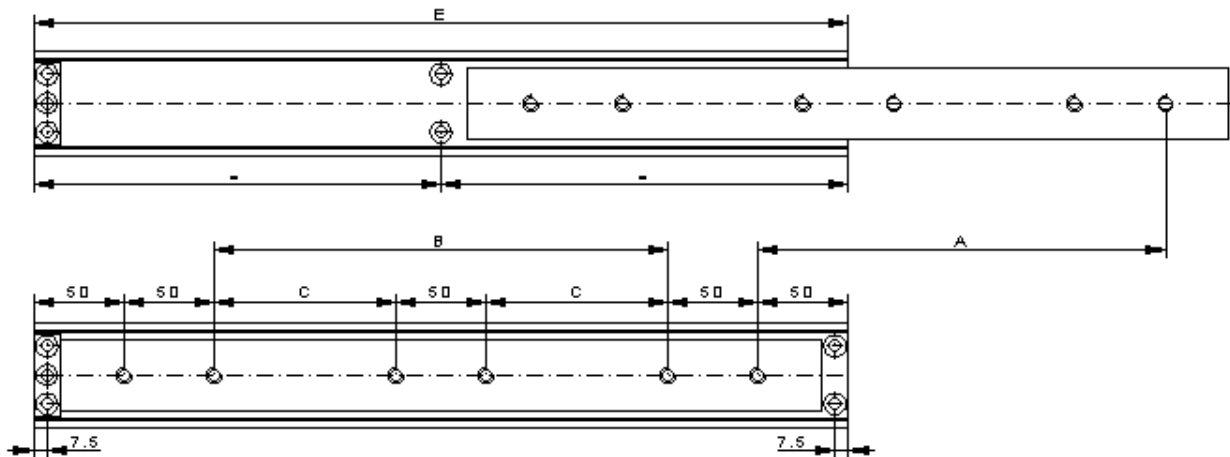
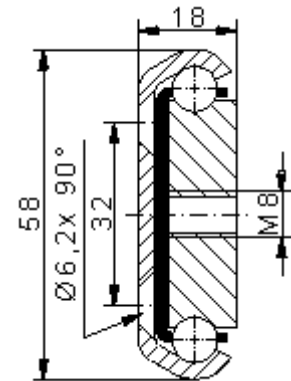

| installation length | length | | | hole pattern | | weight | travel length | load rating per pair |
|---------------------|--------|---|-----|--------------|---|--------|---------------|----------------------|
| | 2 | B | C | 1 | 2 | | | |
| E | 2 | B | C | 1 | 2 | Kg | A | Kg |
| 800 | 770 | | 275 | 6 | 6 | 5,65 | 520 | 200 |
| 850 | 820 | | 300 | 6 | 6 | 6,0 | 570 | 190 |
| 900 | 870 | | 325 | 6 | 6 | 6,36 | 600 | 180 |
| 950 | 920 | | 350 | 6 | 6 | 6,71 | 630 | 170 |
| 1000 | 970 | | 375 | 6 | 6 | 7,06 | 660 | 160 |
| 1100 | 1070 | | 425 | 6 | 6 | 7,8 | 720 | 140 |
| 1200 | 1170 | | 475 | 6 | 6 | 8,5 | 800 | 120 |
| 1300 | 1270 | | 525 | 6 | 6 | 9,2 | 860 | 100 |
| 1400 | 1370 | | 575 | 6 | 6 | 9,9 | 920 | 80 |
| 1500 | 1470 | | 625 | 6 | 6 | 10,6 | 1000 | 60 |